



STORMWATER PLANTERS

DID YOU KNOW?

Water that enters the storm sewer flows directly into our streams, lakes and rivers. By filtering the excess rain water from our streets, we can help to keep these bodies of water clean!



Glass of stormwater runoff before it's filtered by the natural system.

Glass of stormwater runoff after it's filtered by the natural system.

Stormwater planters capture the street's stormwater runoff before it enters into city's storm sewer. By promoting stormwater infiltration, the planters remove pollutants and debris, that would otherwise be released directly into the Mississippi River.

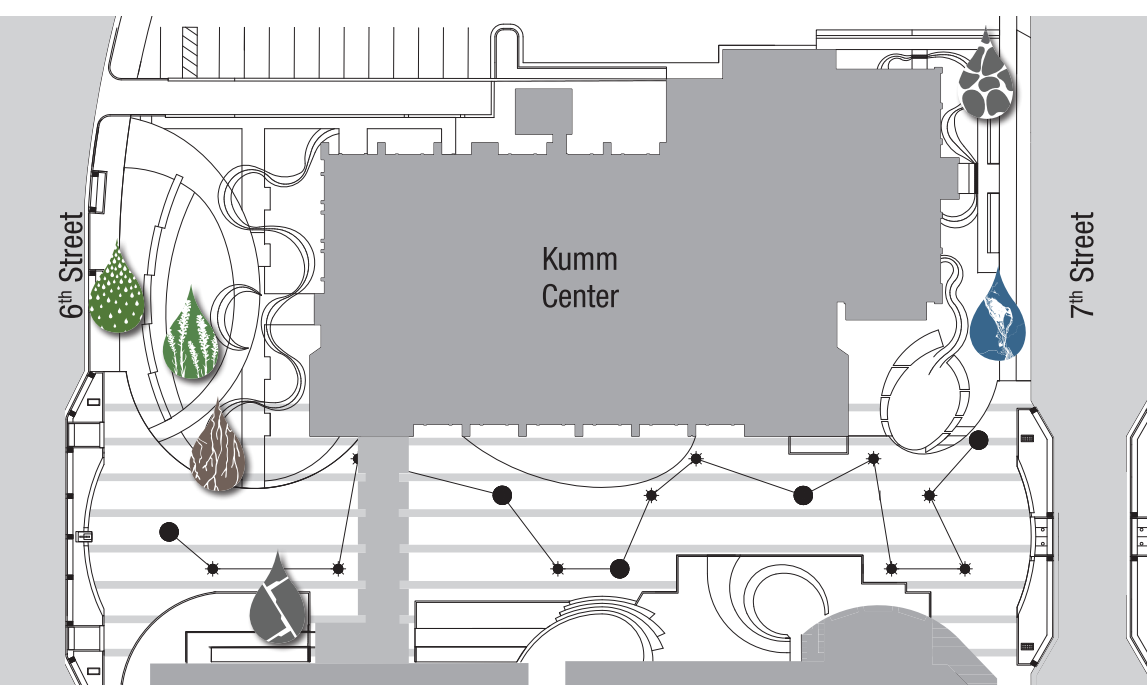
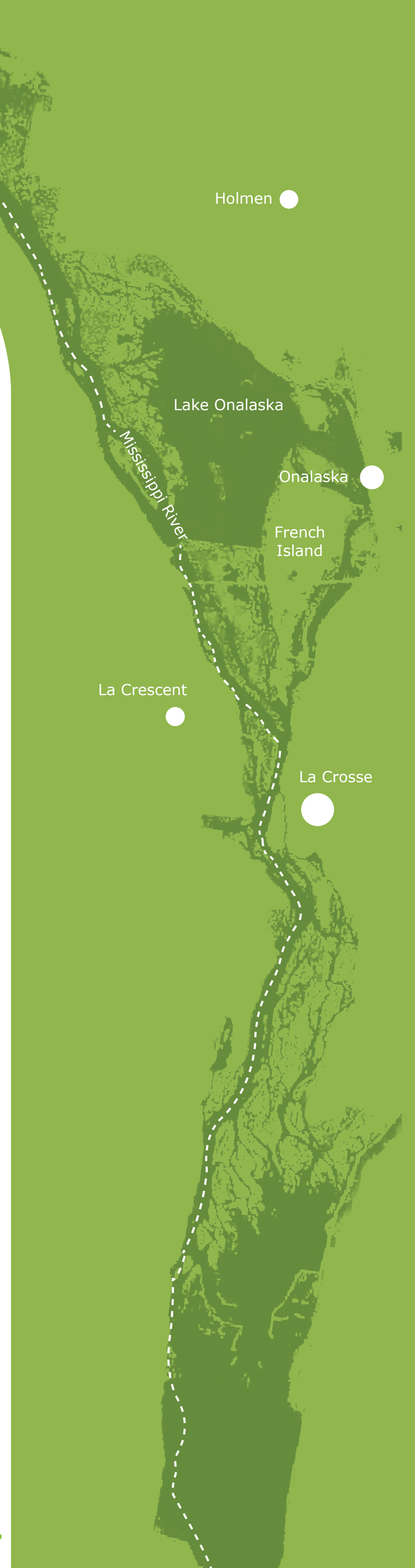
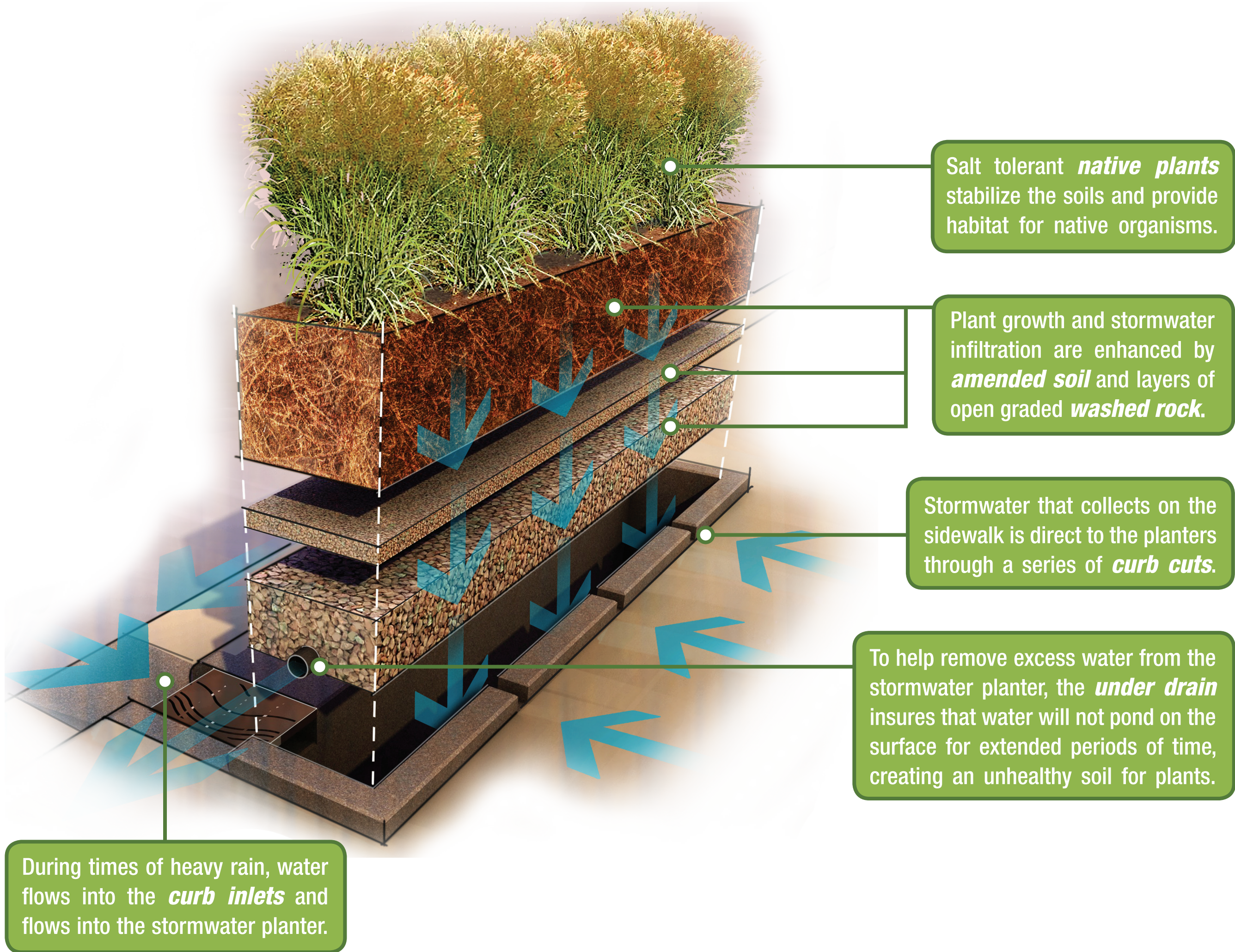

Panel locations on campus

Graphics and Illustrations by RDG Planning & Design

