

PERMEABLE PAVING

DID YOU KNOW?

Permeable pavers help cool, calm and cleanse water as it passes through layers of rock, below the pavement surface.



Thanks to permeable pavers, over 500,000 gallons of stormwater annually will avoid the City's storm sewer.

** Each Gallon equals 20,000 gallons of stormwater

Permeable pavers promote the infiltration of stormwater through a series of small openings within the pavement surface. This reduces the amount of runoff that causes flooding and helps remove pollutants from stormwater.



Spaces between the **permeable pavers** direct water to a series of layers below the pavement sub base.

Layers of uniformly graded **washed rock** allows water to be temporarily stored below the pavement surface before it infiltrates into the existing soils.

Sandy subsoil has a high infiltration rate allowing water to move through the soil at rates greater than 3" per hour.

Pollutants are removed from the stormwater by small beneficial **bacteria** that "digest" and breakdown complex metals and chemicals.

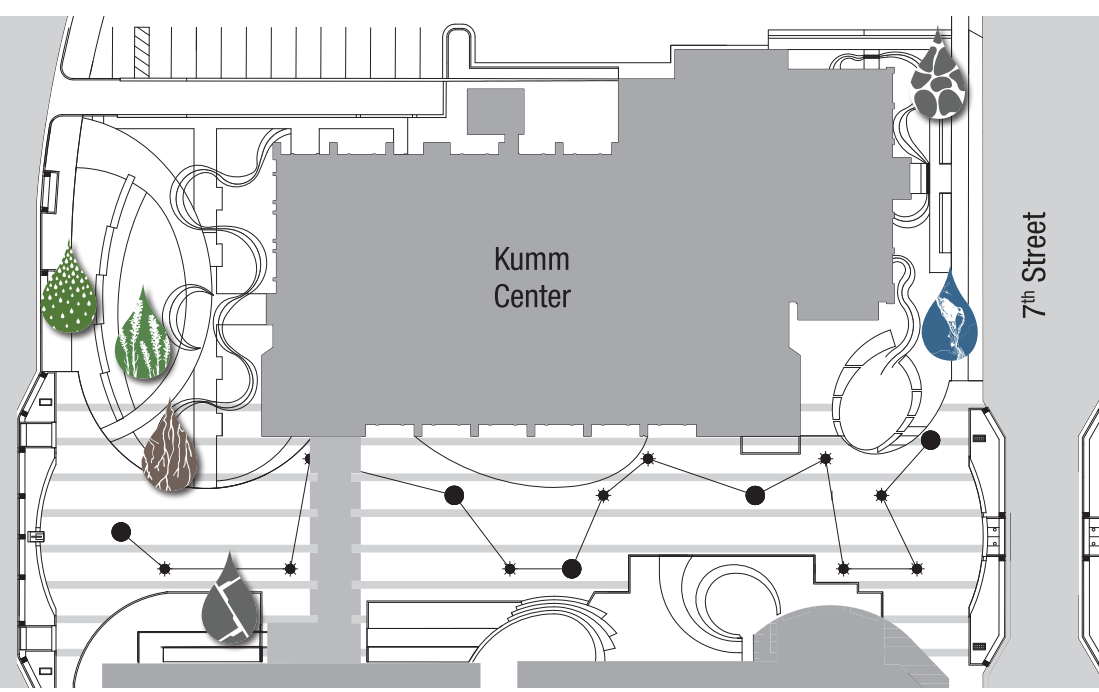
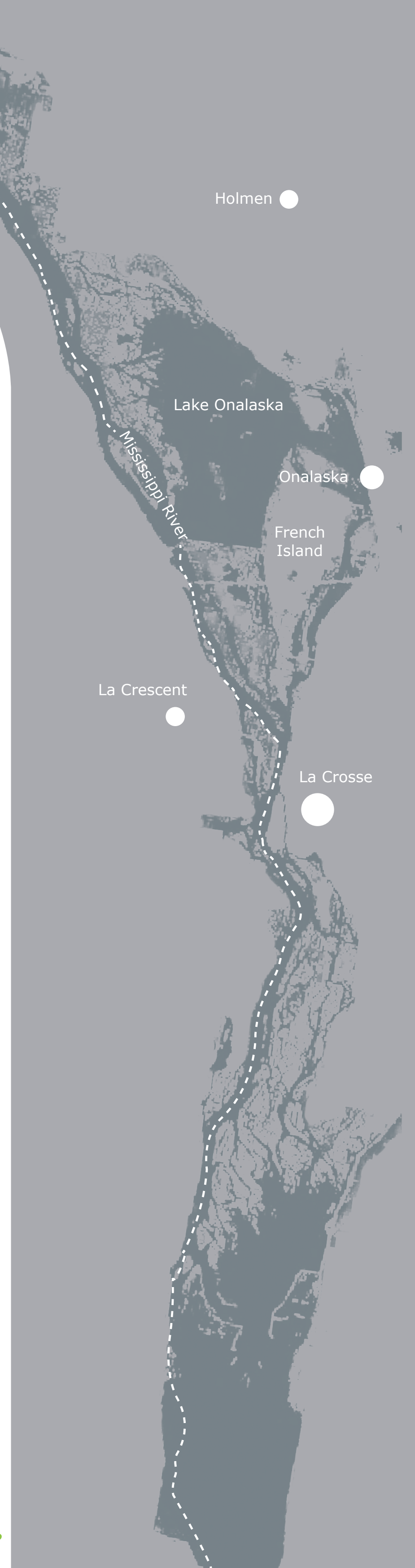

Panel locations on campus

Graphics and Illustrations by RDG Planning & Design

